

環形鼓風機 Ring Blowers

特點：

小型/重量輕/高風壓
前頃式葉片設計，體積小、質量輕且較有高壓力之產生。

低噪音

新設計，能消除切風時產生之高頻及特殊之消音材質，大幅降低噪音比。

低震動

葉片均經過電腦平衡校正與高精密的機械加工，使震動降到最低。

Features:

Low noise and vibration

Dynamic balancing minimizes vibration.

Dust-proofed shaft seal

Protects bearings from Contaminated air stream and possible foreign particle damage.

High reliability

Directly connected motor shaft-impeller provides reliable, long term performance. No gears, belts, motor brushes or sliding blades to require periodic maintenance.

Space-efficient design

Unique design results in substantial airflows at moderate pressures in minimum space and weight.

Versatility

Easily throttled and changed from pressure to suction operation. May be mounted in a variety of fashiond.

Stable airflow

Centrifugal compressor design delivers smooth, stable airflow with no pulsations.

High-pressure airflow

Produces continuous high-pressure airflow. The Ring Blower is ideally suited to many industrial applications.

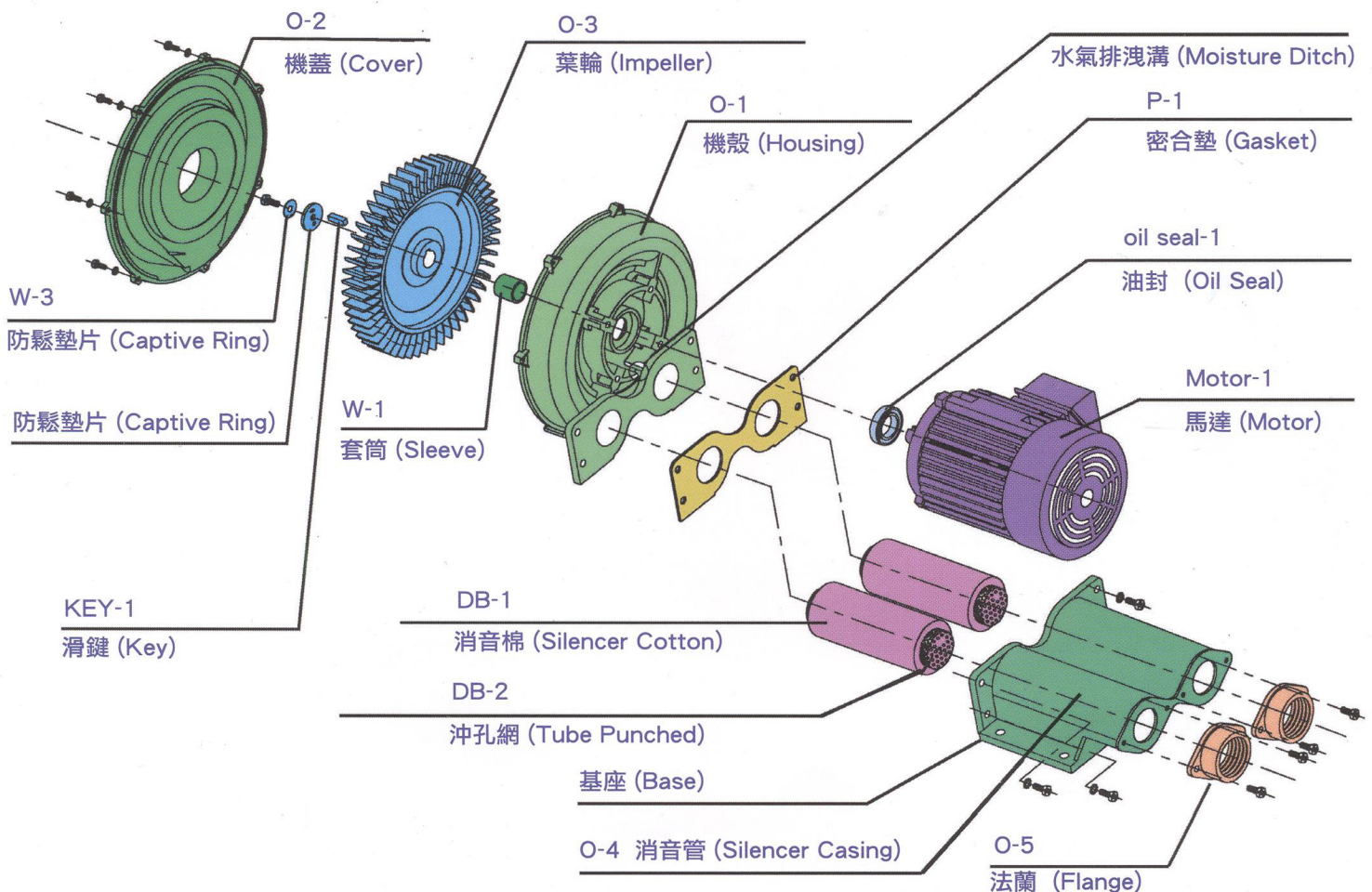

用途：

- ❖ 粉粒體輸送
- ❖ 紡織纖維集塵
- ❖ 裁紙 (布) 機氣墊
- ❖ 污水處理瀑氣
- ❖ 窯業、礦業空氣
- ❖ 重油噴燃
- ❖ 造紙紙漿脱水
- ❖ 無梭織布機專用
- ❖ 玻璃工業及冰廠空氣泵
- ❖ 隧道工程壓送空氣
- ❖ 水產養殖氧氣供給

Applications:

- ❖ Grain Elevators
- ❖ Textile Fiber Collections
- ❖ Paper Industry
- ❖ Sewage Treatments
- ❖ Cement Manufacturing
- ❖ Diesel Burning
- ❖ Pulp Industry
- ❖ Glass Manufacturing
- ❖ Ice Manufacturing
- ❖ Tunnel Ventilation
- ❖ Fishery Industry



TS-018



TS-075



TS-550



TS-1015

規格性能表 Specifications

型式 Type	相數 Phase	頻率 Frequency Hz	輸出 功率 Power KW	輸入 電壓 Voltage V	滿載 電流 Current A	最大靜壓 (吐出) Pressure(max) mm H ₂ O	最大風量 (吐出) Air Flow(max) m ³ /min	出入口徑 In/Put Let	噪音 Noise Level dB	重量 Weight kgs	庫存 區分 Store	
標準形單相 Standard of Single Phase	TS-018S	1Ø	50/60	0.18	110/220	2.4/1.2	500/700	0.6/0.8	PF 1"	60/65	9	V
	TS-037S	1Ø	50/60	0.37	110/220	5/2.5	1000/1200	1.3/1.5	PF 1 1/4"	65/70	15	V
	TS-075S	1Ø	50/60	0.74	110/220	14/7	1600/1800	2.4/2.6	PF 1 1/2"	67/72	20	V
	TS-150S	1Ø	50/60	1.5	110/220	30/15	2000/2500	3.2/4.5	PF 2"	70/75	35	V
	TS-220S	1Ø	50/60	2.2	110/220	44/22	2500/2800	5/6.2	PF 2"	70/75	40	
標準形三相 Standard of Three Phase	TS-018	3Ø	50/60	0.18	220/380	1.2	500/700	0.6/0.8	PF 1"	60/65	9	V
	TS-037	3Ø	50/60	0.37	220/380	1.8	1000/1200	1.3/1.5	PF 1 1/4"	65/70	15	V
	TS-075	3Ø	50/60	0.74	220/380	3	1600/1800	2/2.2	PF 1 1/2"	67/72	20	V
	TS-150	3Ø	50/60	1.5	220/380	5.4	2000/2500	3.2/4.5	PF 2"	70/75	30	V
	TS-220	3Ø	50/60	2.2	220/380	8	2500/2800	5/6.2	PF 2"	70/75	35	V
	TS-370	3Ø	50/60	3.7	220/380	13	2800/3500	7/8.3	PF 2"	77/78	55	V
	TS-550	3Ø	50/60	5.5	220/380	19	2600/3200	7.5/9.5	PF 2 1/2"	80/85	85	V
	TS-750	3Ø	50/60	7.5	220/380	24	2900/3400	9/11	PF 2 1/2"	80/85	95	V
	TS-1011	3Ø	50/60	11	220/380	36	2500/3000	20/24	PF 4"	82/87	175	
TS-1015	3Ø	50/60	15	220/380	47	3000/3500	25/28	PF 4"	82/87	182		

性能比較圖 Comparison with Function

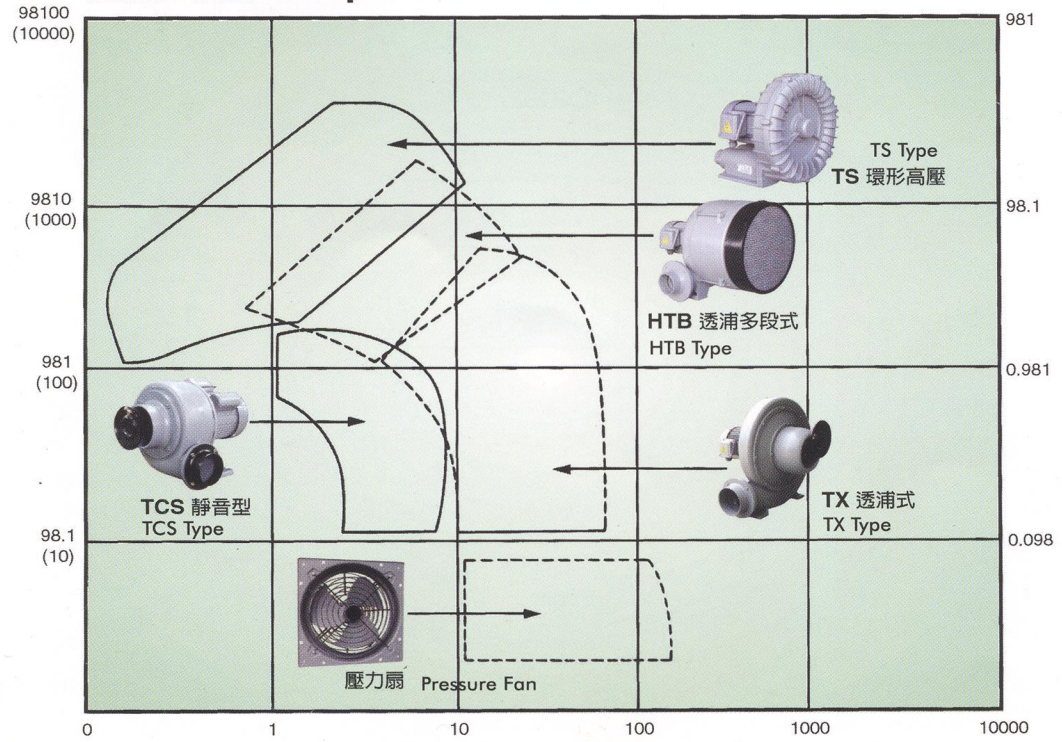

性能曲線圖 performance Curve



TS-220

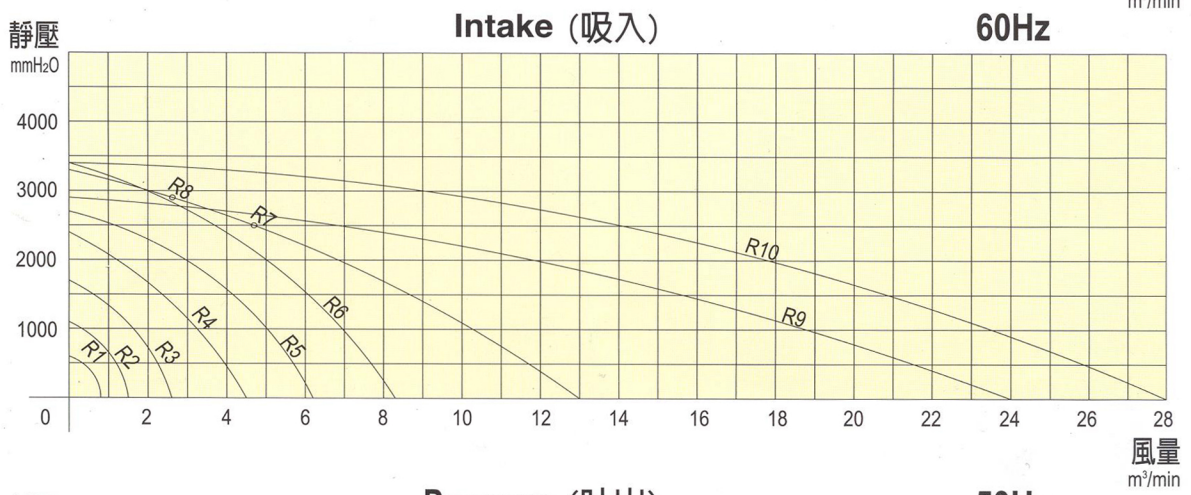
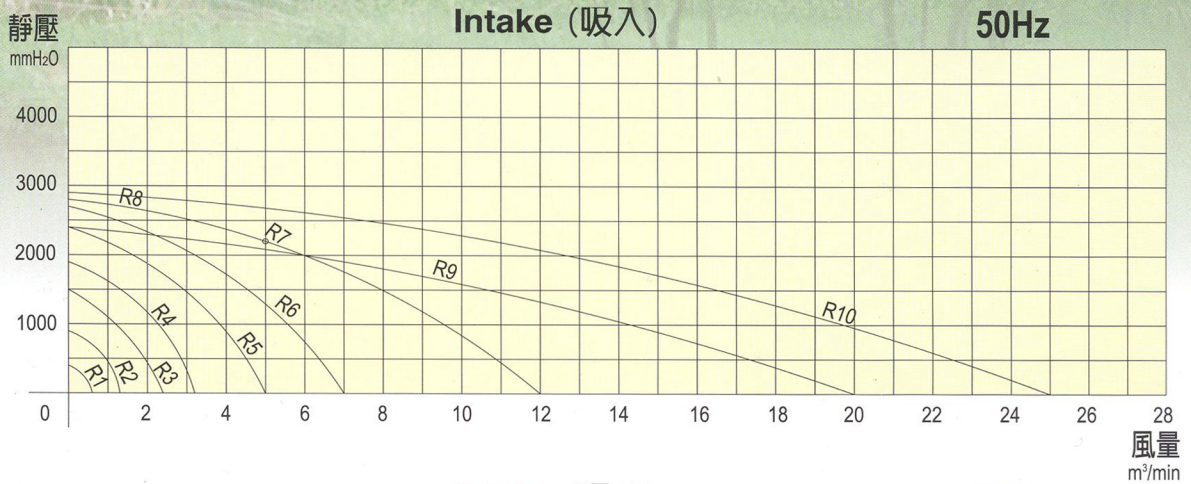

品號	品名
R1	TS-018S
R2	TS-037S
R3	TS-075S
R4	TS-150
R5	TS-220
R6	TS-370
R7	TS-550
R8	TS-750
R9	TS-1011
R10	TS-1015

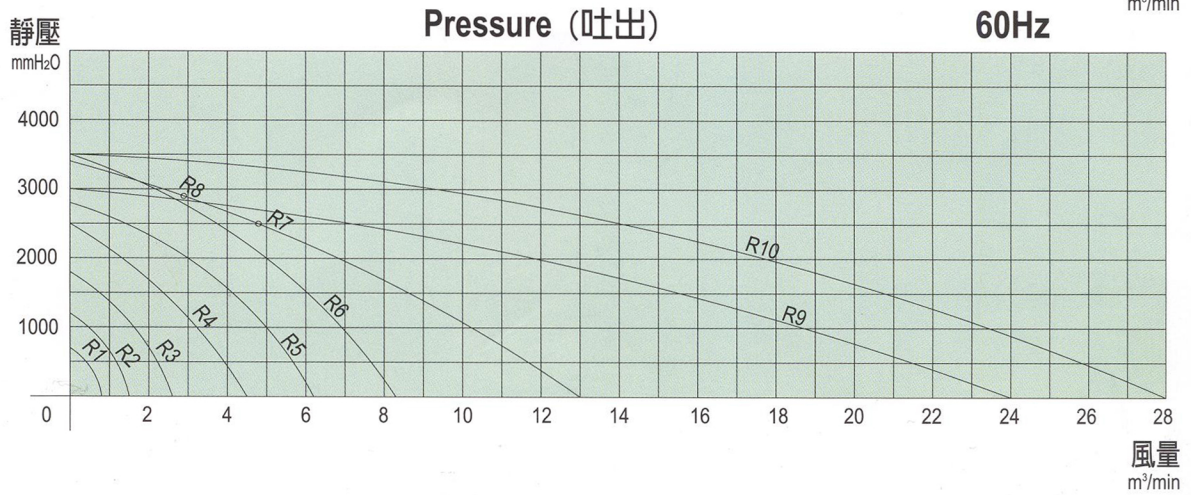
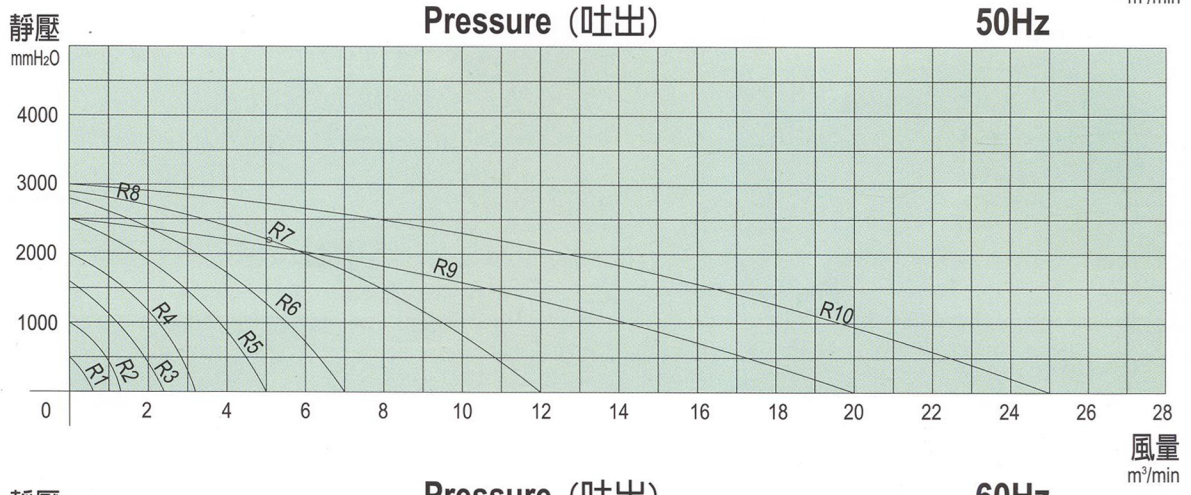

TS-1011

外型尺寸圖 Outside Dimensions

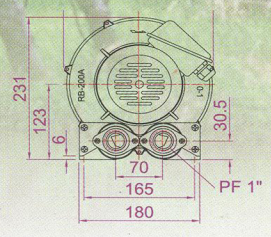

TS-018

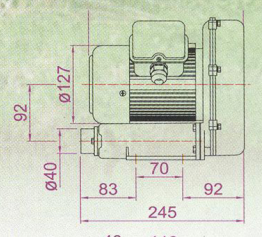

TS-220

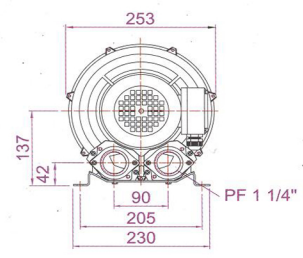
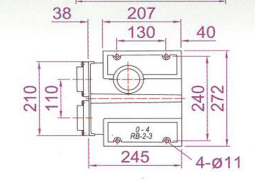
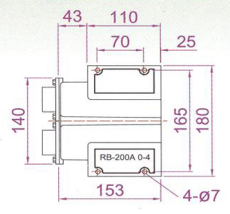
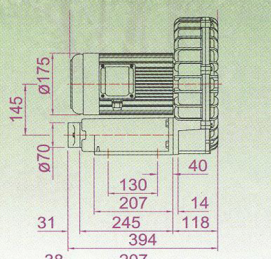
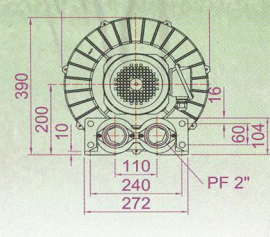

TS-037

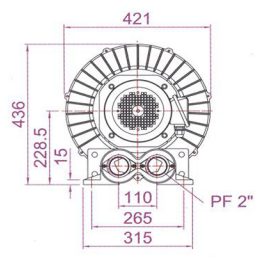
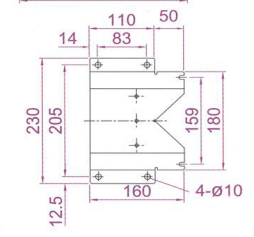
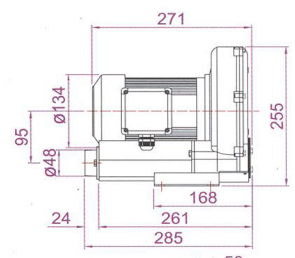

TS-370

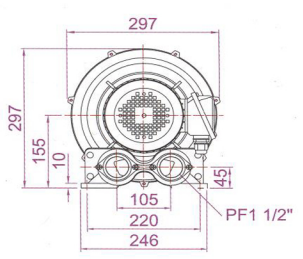
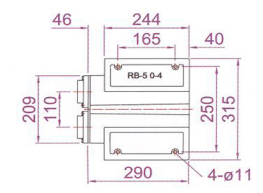
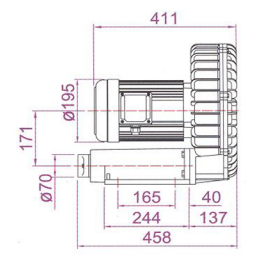

TS-075

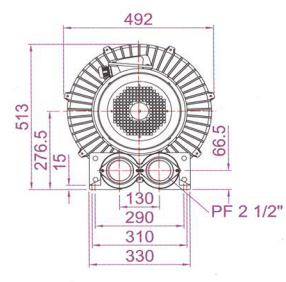
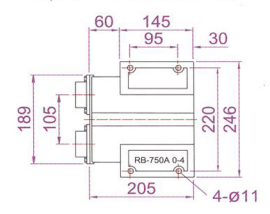
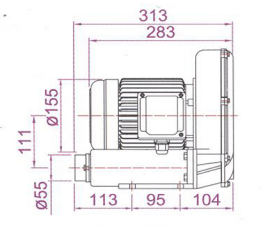

TS-550(750)

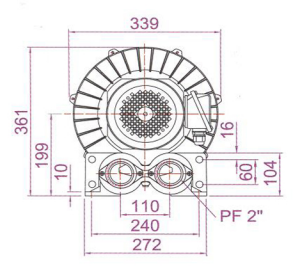
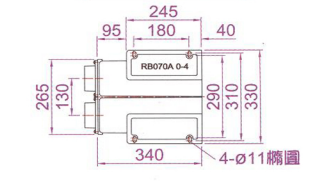
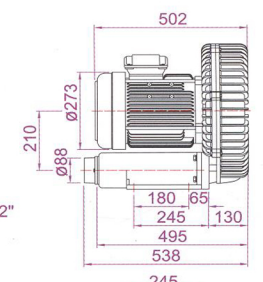

TS-150

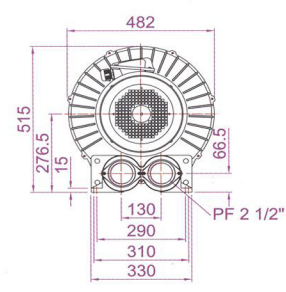
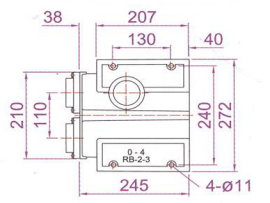
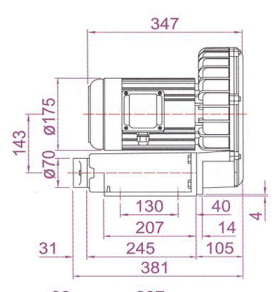

TS-1011

